

# SILVERFOX

## F-830 ROTARY BRUSH

### User Manual

Welcome to use our product.  
The manufacturer reserves the right to improve design and  
modify the product without prior notice.  
Version A2



## About This Manual

This manual is provided solely for reference in operating this specific model. If this manual is used for any purpose other than operating the specified model, manufacturer shall not be liable for any consequences or damages arising therefrom. All information contained herein is protected by copyright. No part of this manual may be reproduced, translated, or otherwise exploited without the prior written permission of manufacturer.

## Safety Guidance

**Safety Guidance To ensure you use this product correctly and safely, please read all instructions before use! Follow all safety precautions in the manual.**

**To ensure your correct and safe use of this product, please read all the instructions before use! Please follow all safety precautions!**

	<b>Warning!</b>	<p><b>Indicates a potentially hazardous situation that could result in serious loss of life.</b></p> <ul style="list-style-type: none"><li>• This product is for use by qualified beauticians only.</li><li>• Do not use or store this product in damp areas, such as bathrooms, to avoid malfunction or danger.</li><li>• Do not use this product near flammable materials (such as alcohol, thinner, gasoline, nail polish remover, aerosol sprays, etc.).</li><li>• Do not use this product if the power cord or plug is damaged or hot, or if the plug is loose in the power outlet.</li><li>• Do not plug or unplug the power cord connector or use this product with wet hands.</li><li>• Make sure the operating voltage of this product meets its rated voltage.</li><li>• Before use, ensure that the power plug and power cord connector are fully inserted to avoid danger.</li><li>• When this product is not in use, turn off the power and unplug it.</li><li>• Regularly clean the power plug and power cord connector to prevent insulation failure due to moisture, dust, etc.</li><li>• Use the power cord assembly specifically for this product. Do not use the power cord assembly with other electrical appliances.</li><li>• Do not wrap the power cord around this product, as this may cause deformation and malfunction. Keep this product out of reach of children. Do not allow children to use this product.</li><li>• Do not modify, disassemble, or repair this product yourself. If repairs are required, contact the manufacturer, distributor, or qualified repair personnel for inspection and repair to avoid any danger.</li><li>• If the plug is damaged, contact the dealer, service center, or qualified personnel with the necessary skills and experience to repair it.</li></ul>
	<b>Attention!</b>	<p><b>Indicates a potentially hazardous situation that could result in personal injury.</b></p> <ul style="list-style-type: none"><li>• The operator should pay special attention to personal and equipment safety during use.</li><li>• If any malfunction occurs with the product, discontinue use immediately and contact the manufacturer or distributor for appropriate action.</li><li>• Handle this product and its accessories with care.</li><li>• Properly dispose of the packaging to prevent suffocation and other hazards. Keep this product out of reach of children.</li></ul>

# Components

No.	PRODUCT	QTY.
1	Rotary Brush Handle	1
2	Large bristle brush	1
3	Medium bristle brush	1
4	Small bristle brush	1
5	Large Gesso Brush	1
6	Small Gesso Brush	1
7	Main Unit	1
8	Power Cord	1

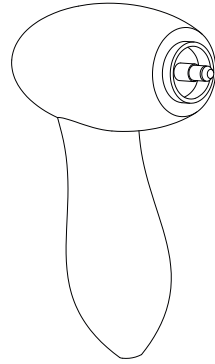

1. Rotary Brush Handle

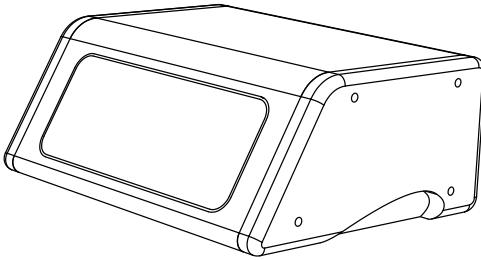

7. Main Unit

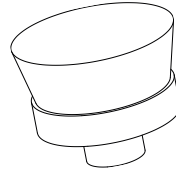

2. Large bristle brush

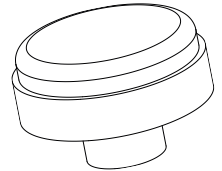

5. Large Gesso Brush

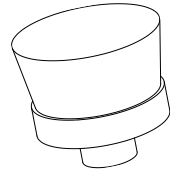

3. Medium bristle brush

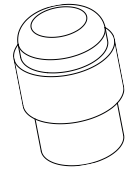

6. Small Gesso Brush

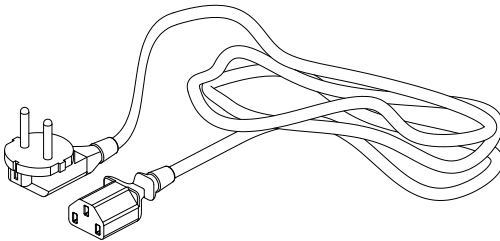

8. Power Cord



4. Small bristle brush

### ◆ FRONT PANEL/REAR PANEL

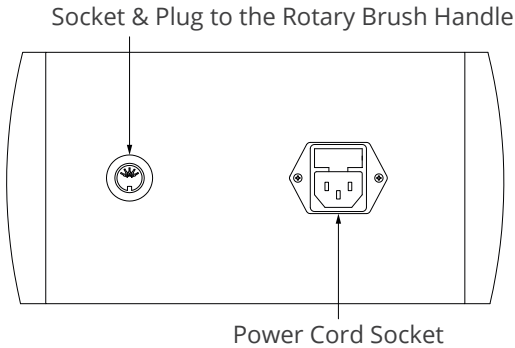
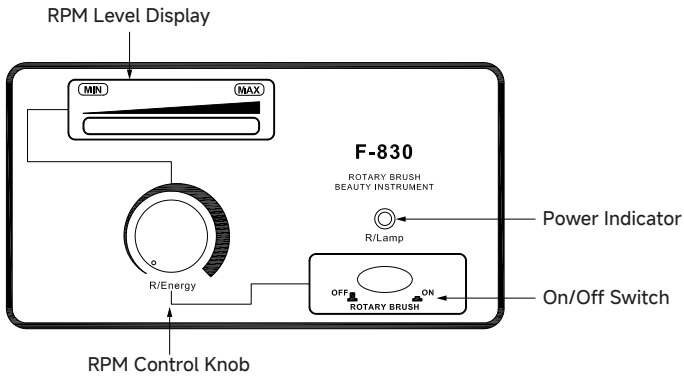

## Product Parameters

Product name	ROTARY BRUSH
Product model	F-830
Package size	360×310×185(mm)
Gross weight	4.3 kg
Speed of rotation	200-800 RPM
Rated voltage	AC 100-120V / AC 220-240V
Frequency	50/60Hz
Power	25W

## Operation Method

Before treatment:

1. Scrub the skin surface with a damp pad.
2. Use a steamer (or hot towel) to soften the skin surface in the treatment area.
3. After cleansing and conditioning the skin, it is recommended to apply some nourishing oil to the target skin surface.

Beginning treatment:

1. Connect the power cord to power cord socket located at the rear panel.
2. Connect the Rotary Brush Handle plug to the socket located at the rear panel.
3. Select the appropriate brush based on the patient's skin type. Generally, delicate or dry skin requires a bristle brush, while rough or oily skin can use a gesso brush (see the brush diagram on the next page)
4. Hold the Rotary brush handle in hand, turn on the "On/Off" Switch, adjust the RPM control knob to adjust the speed of the rotation.

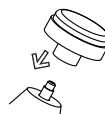

Precautions

1. Do not apply excessive pressure to the brush head while the device is operating.
2. Do not use this device with any significantly acidic or alkaline substances.
3. After operation, turn off the device and unplug the power cord.
4. Customers with allergic skin or dermatitis should not use this function.
5. Do not use this function to cleanse the skin if the capillaries in the skin are damaged.

Maintenance

1. After operation, remove the brush from the handle, soak the brush in clean water with a small amount of detergent for 5 minutes. Then, rinse it thoroughly and soak it in alcohol for half an hour.
2. The brush head must be sterilized using ultraviolet light and stored in its original packaging.

Large Bristle Brush	All Skin Types Gentle exfoliation of larger surface areas such back and chest.
Medium Bristle Brush	All Skin Types Gentle exfoliation of larger surface areas such as cheek, forehead, chin.
Small Bristle Brush	All Skin Types Gentle exfoliation of smaller surfaces such as the eye and nose area.
Large Gesso Brush	Can be used on All Skin Types. Best for thick skin. Assists in elimination of excess oil, dirt and cell build up on larger surface areas such as cheek, forehead, chin, back and chest.
Small Gesso Brush	Can be used on All Skin Types. Best for thick skin. Assists in elimination of excess oil, dirt and cell build up on smaller surfaces such as the eye and nose area.



Do not dispose of old or defective appliances in domestic garbage; this should only be done through public collection points.

- ▲ Product components may be subject to changes without prior notice. Actual appearance may vary from images.