

SILVERFOX

2240 / 2240B

Facial Chair

Welcome to use our products. A2
Please read the user manual carefully before using the products.
Our company reserves the right to improve design and modify
the products without prior notice.

1. About This Manual

This manual shall only be used for the reference of operation of this particular model. If the manual is used for other purposes, SILVERFOX will not undertake any according consequences and responsibility. All information of this manual shall be protected by copyright and shall not be copied and translated in any part of this specification without the written consent of our company SILVERFOX.

2. Warning

- Power must be cut off when changing electrical components or maintaining and cleaning machines.
- The plug must be plugged into an outlet that is properly installed and grounded, to prevent the risk of fire and electric shock.
- Do not stand on this equipment.
- Do not allow children to play with and place the equipment in a place where children can touch. Please adjust the backrest to the highest position when you leave.
- Please do not place the equipment in wet places such as bathroom to avoid electric shock or other failure; Also keep the controllers away from water.
- Please do not place and operate the equipment in places where is painting/coating or supplying oxygen.
- Unless being monitored or instructed by personnel who can be responsible for their personal safety, the people who have physical obstacles, tactile disorders, mental disorders, lack of experience, common sense or children, are not allowed to use the equipment.
- Please contact distributor, service center or related personal with appropriate skill and experience for repairing if the plug is damaged, in case of any danger.
- Please make sure there is no accessible thing within the stroke during any operation of the products.
- Operation should be processed by trained professionals.

3. Precautions

- This product should be used by an experienced person who must be familiar with the product structure, performance and instructions. And make the regular maintenance work.
- Read this manual carefully before installation, operation and adjustment. And please keep it well.
- This product shall not be used for single side or single point loading work.
- Comply with safety operation rules, product shall not be overloading, and to ensure that the product safety protection equipment is complete and reliable, eliminates unsafe factors on time.
- Tighten bolts and nuts regularly to avoid failure caused by loose, sliding, vibration and falling off.
- During the maintenance, the operator shall not disassemble any parts of the product at will.
- This product is not allowed to operate when it's with fault. If abnormal phenomenon or abnormal sound is found, it must be stopped for inspection immediately, and work can be resumed after troubleshooting.
- The operator must be familiar with the precautions descriproduct in each section of the manual to ensure the safety of person and product.
- This product is equipped with a three-wire power cord. The power cord must be plugged into a three-hole outlet which is properly installed and grounded. This is not only to prevent the risk of electric shock, but ensure product can work properly.
- Please operate the product strictly accordance with the warning label stamped on it.
- While controlling the lifting, the button must be pressed continuously until the product in a suitable position.
- Please pay attention that the continuous working times should be Max. 2Min. ON ; 18Min. OFF, when operating the motor.
- Maintenance should be processed by trained professionals.
- After every treatment, please only use neutral solution to clear the dust or stains on the product.
- When adjusting each part, please keep your hands, feet and head away from the position indicated by the arrow. (As shown in the photo)

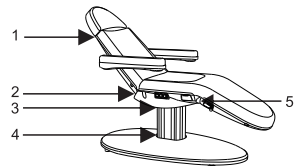

4. Installation

1. Put the product to a proper location, according to the overall layout, the daylighting or artificial lightings and operation condition of the salon's or the home. And keep it in the clean, dry and cool environment.
2. Open the packing carton to check if the product is intact and whether the accessories or spares are complete. Please contact distributor or us if there's any problem.
3. Installation
Place the product to the proper position. Please note that it is unnecessary to install extra screw on the floor to fasten the product, because the original design has taken the stability into consideration. But please ensure the product is placed on a firm and flat ground, so as to prevent any accident. If the product rotates or slant due to rough ground, please adjust the four pieces of plastic feet (M10×30) and nuts (M10) by hexagon open-end wrench, which are fasten on the bottom panel, so as to ensure the product is stable.
4. Connect the plug of product with power supply properly. (As shown in the photo)

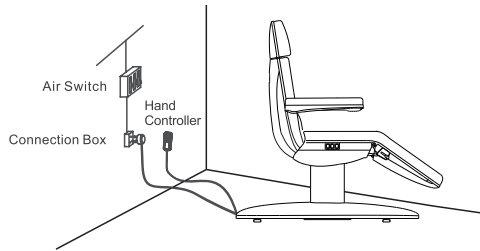

5. Structure of products

- This product consists of control box, motor, wooden part, hardware, plastic parts and leather. Among them, the control box is controlling the operation of the motors and the hand controller.
- This product includes angle adjustment of the backrest, angle adjustment of the seat cushion and lifting adjustment which is an overall and integral structure. (As shown in the photo)

2240

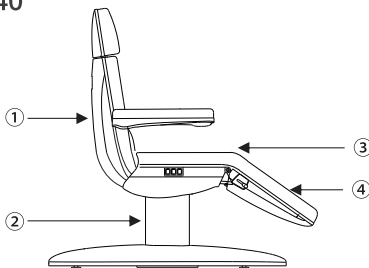

- ① angle adjustment of the backrest
- ② lifting adjustment
- ③ angle adjustment of the seat
- ④ angle adjustment of the footrest (manual adjustment)

2240B

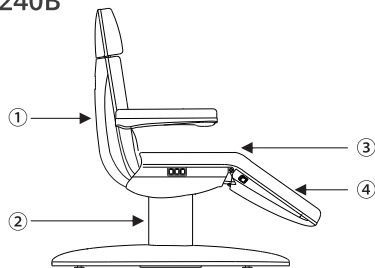

- ① angle adjustment of the backrest
- ② lifting adjustment
- ③ angle adjustment of the seat
- ④ angle adjustment of the footrest

6. Operation Instruction

2240

Standard Configuration (Rocker Switch)

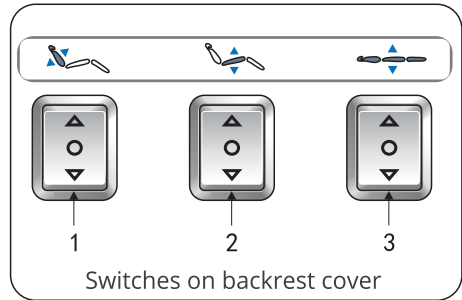
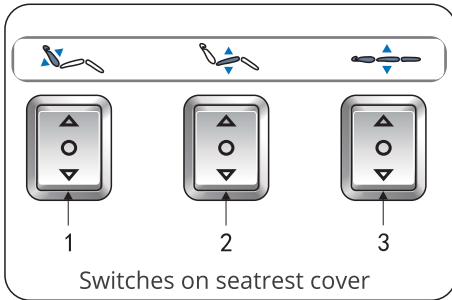

No.	Description	Operation
1	Button for Backrest Adjustment	Press button up (down), backrest moves up (down), angle increases (decreases) at a constant speed.
2	Button for Seat Adjustment	Press button up (down), seat inclines backward (moves back to horizontal position).
3	Button for Height Control	Press button up (down), seat moves up (down), height increases (decreases) at a constant speed.

2240B

Standard Configuration (Rocker Switch)

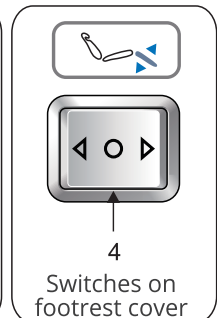
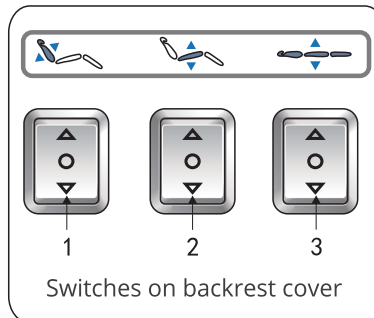
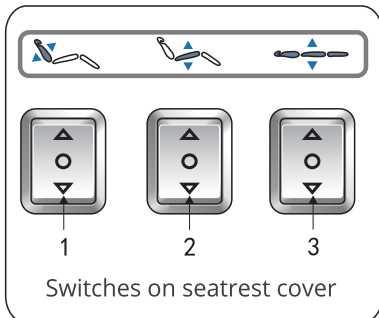

No.	Description	Operation
1	Button for Backrest Adjustment	Press button up (down), backrest moves up (down), angle increases (decreases) at a constant speed.
2	Button for Seat Adjustment	Press button up (down), seat inclines backward (moves back to horizontal position).
3	Button for Height Control	Press button up (down), seat moves up (down), height increases (decreases) at a constant speed.
4	Button for Footrest Adjustment	Press button up (down), footrest moves up (down), angle decreases (increases) at a constant speed.

2240

1.Optional Configuration
(Hand Controller)

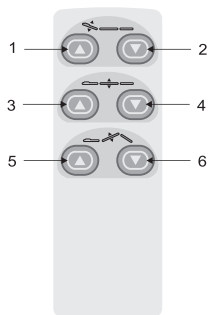

2.Optional Configuration
(Hand Controller)

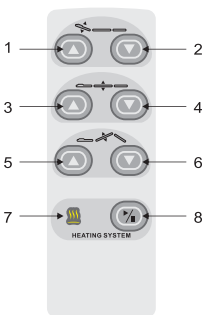

3.Optional Configuration
(Foot Controller)

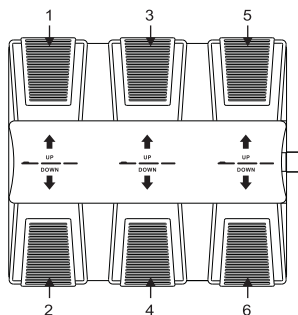

No.	Description	Operation
1	Backrest moves up	Backrest goes up smoothly by pressing the button.
2	Backrest moves down	Backrest goes down smoothly by pressing the button
3	moves up	moves up smoothly by pressing the button
4	moves down	moves down smoothly by pressing the button
5	Seat cushion up	Seat inclining smoothly by pressing the button
6	Seat cushion down	Seat goes flat smoothly by pressing the button
7	Indicator light of heating function	Pressing the button, the light is on, the heating function works; pressing the button again, the light is off, the heating function stops.
8	Heating button	

2240B

1.Optional Configuration
(Hand Controller)

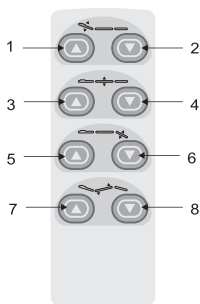

2.Optional Configuration
(Hand Controller)

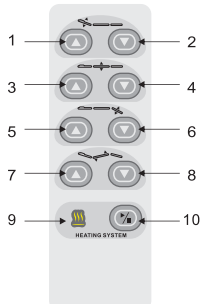

3.Optional Configuration
(Foot Controller)

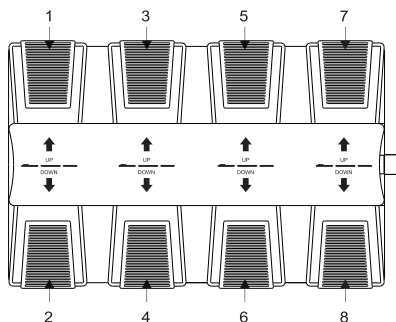

No.	Description	Operation
1	Backrest moves up	Backrest goes up smoothly by pressing the button.
2	Backrest moves down	Backrest goes down smoothly by pressing the button
3	moves up	moves up smoothly by pressing the button
4	moves down	moves down smoothly by pressing the button
5	Footrest moves up	Press the button, footrest will move up, its angle will be reduced to minimum.
6	Footrest moves down	Press the button, footrest will move down, its angle will be moved to maximum.
7	Seat cushion up	Seat inclining smoothly by pressing the button
8	Seat cushion down	Seat goes flat smoothly by pressing the button
9	Indicator light of heating function	Pressing the button, the light is on, the heating function works; pressing the button again, the light is off, the heating function stops.
10	Heating button	

Notes:

- 1.The memory position setting is only available for the models with memory function.
- 2.The heating function is only available for the models with heating function.
- 3.Different hand controllers should be chosen according to different configuration.

7. Technical Parameters

Power	AC 100-120V or AC 220-240V or AC 100-240V, 50/60Hz
Power Rating	300W
Environment Temperature	0°C~+40°C
Relative Humidity	30%~90%
Lifting Rated Load	175kg
Package Size	170×65×70cm

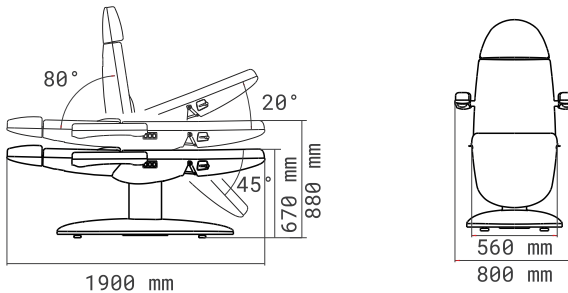

8. Maintenance

1. After every treatment, please only use neutral solution to clear the dust, stains on leather, metal part or other parts. Disinfecting solution like alcohol, acid or alkaline solution are forbidden. This is to prevent the lifetime of the components from being shortened.
2. Please lubricate the moving parts regularly (once a year)

9. Circuit System Connection Diagram

2240

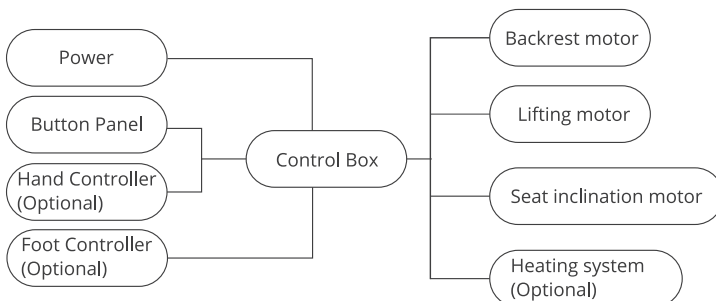

2240B

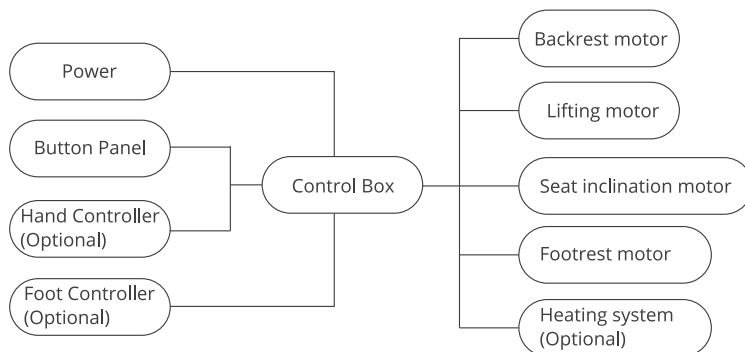

10. Troubleshooting

The Fault Phenomenon	Reason	Solution
motor can't work normally	1. The power cord is unconnected or not plugged well.	Connect the power cord or plug it well.
	2. Poor quality of the hand controller or foot controller.	Replace the hand controller or foot controller.
	3. Poor quality of the control box.	Please contact maintenance center or supplier for troubleshooting.
	4. Repture of motor tail.	
	5. Motor was damaged.	
Abnormal Sound	1. The rotating parts are short of lubricating oil.	1. Add lubricating oil.
	2. Rotating positions (such as hinge, POM sets, gas lift) are short of lubricating oil.	2. Add lubricating oil.
	3. Motor quality problems.	3. Replace the motor.

If problem is still not solved after above operations, please contact maintenance center or supplier to solve it.



Do not dispose of old or defective appliances in domestic garbage; this should only be done through public collection points.

▲ Please check the product specification before use. This manual is for reference only. Specifications are subject to change without prior notice.